

12 Margaret Street

WHIFFLET, COATBRIDGE, NORTH LANARKSHIRE, ML5 4DR

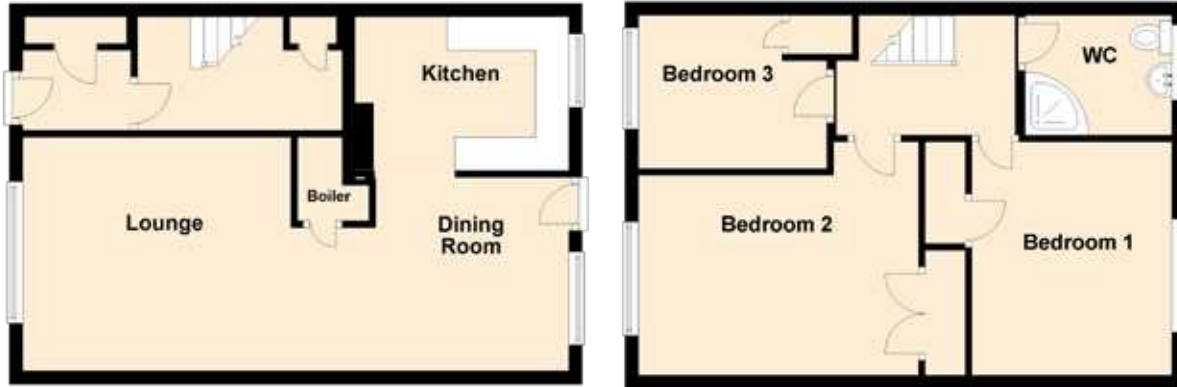

Approximate Dimensions (Taken from the widest point)

Lounge	4.80m (15'9") x 3.50m (11'6")
Dining Room	3.30m (10'10") x 2.90m (9'6")
Kitchen	2.90m (9'6") x 2.30m (7'7")
WC	2.20m (7'3") x 1.90m (6'3")
Bedroom 1	3.50m (11'6") x 3.00m (9'10")
Bedroom 2	4.20m (13'9") x 3.00m (9'10")
Bedroom 3	2.83m (9'3") x 2.30m (7'7")

Gross internal floor area (m²) - 87m²

EPC Rating - C