

7 St Anne's Path, Lasswade, EH18 1DR.



For Sale

Rarely available terraced villa enviably located on the edge of the countryside, adjacent to a grazing field, with fabulous panoramic view towards the Pentland Hills. Well presented and spacious accommodation comprising hallway, downstairs WC., lounge/dining room, modern fitted kitchen, 3 bedrooms and luxuriously fitted bathroom with shower above bath. Loft space. Gas central heating. Double glazing. Gardens to front and rear including fully enclosed rear garden with gate leading to nearby lock up garage within cul de sac. Ideal family home within truly idyllic and picturesque setting.



St Annes Path, just off Polton Road West, lies approximately 9 miles South East of Edinburgh City Centre with excellent public transport services along with the A720 Edinburgh City By-Pass and A7 allowing for ease of commuting out with the area. Bonnyrigg has a wide range of amenities to meet everyday needs including Primary and Secondary schools, shops, supermarkets and leisure centre with swimming pool. It is also worth noting the surrounding countryside allows for a number of outdoor pursuits with a number of retail parks also in close proximity



Energy Performance Rating C

Viewing

By appointment on 0131 226 9167

GROUND FLOOR

1ST FLOOR

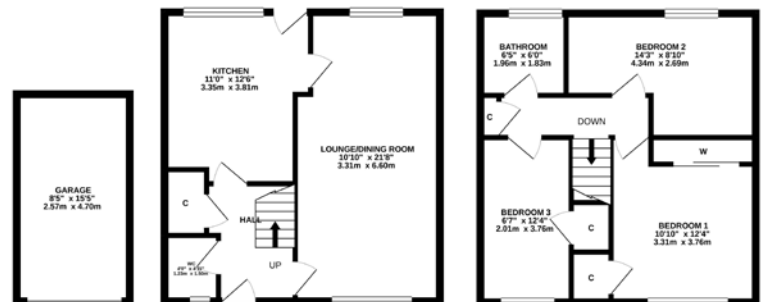

Whilst every attempt has been made to ensure the accuracy of the floorplan contained here, measurements of doors, windows, rooms and any other items are approximate and no responsibility is taken for any error, omission or mis-statement. This plan is for illustrative purposes only and should be used as such for any prospective purchase. The services, systems and appliances shown have not been tested and no guarantee as to their operability or efficiency can be given. Made with Metreage ©2020