



End Terraced House

11 Woodlea Court, Kilmarnock, KA2 0ES





11 Woodlea Court

Taylor and Henderson are delighted to bring to the market this End Terraced Villa located within easy walking distance to all local amenities and public transport stations.

The spacious accommodation on offer comprises spacious Entrance Hallway, Lounge/Dining Room with feature fireplace, Kitchen with door leading to the Conservatory, on the ground floor. Upstairs boasts 2 Double Bedrooms and Bathroom.

There is a Driveway leading to the Garage with additional roof space.

The easily maintained garden to the front is laid on decorative chips and the rear is paved. The property benefits from Gas Central Heating, Double Glazing & Generous Storage.

Crosshouse is a village on the outskirts of Kilmarnock offering local amenities to include a Primary School and a variety of shops. There are road and bus links to all major surrounding towns.

Measurements

Reception Hallway	
Lounge/Dining Room	12' ext 20'9 x 11'3
Kitchen	9'8 x 9'8
Bedroom 1	13'7 x 8'4
Bedroom 2	10' x 10'
Bathroom	7'2 x 5'5

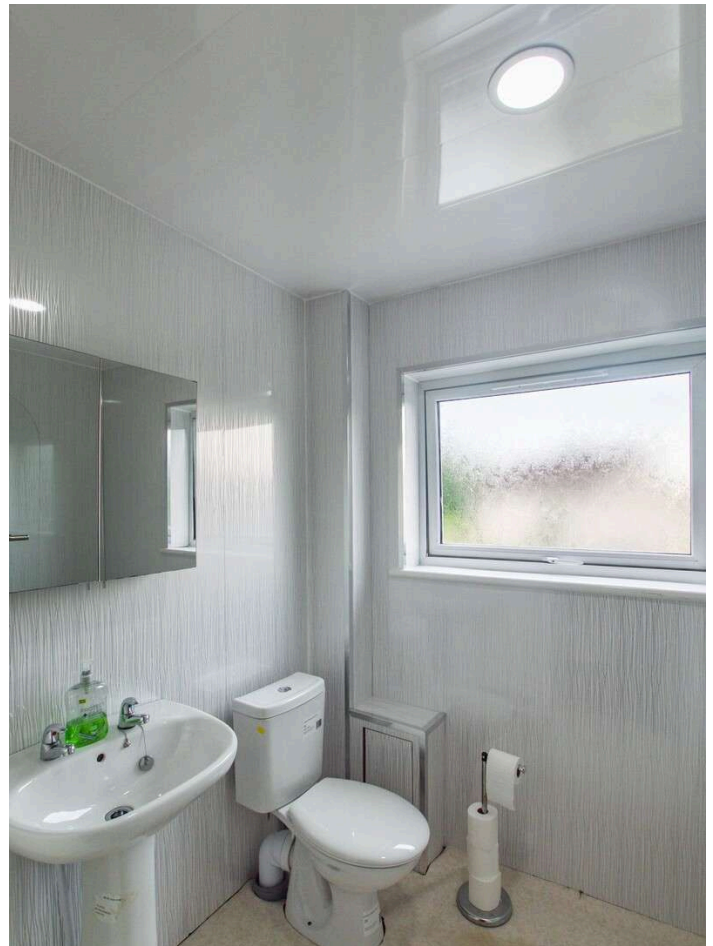

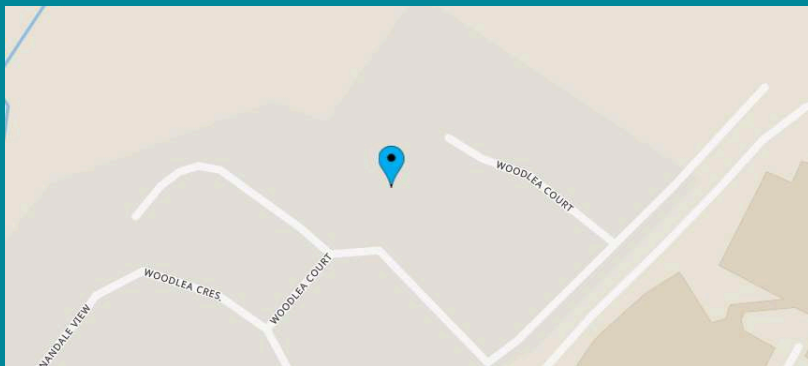

Viewing
Through solicitors on 01294 606700

Email
property@taylorandhenderson.co.uk

Reference
E478786

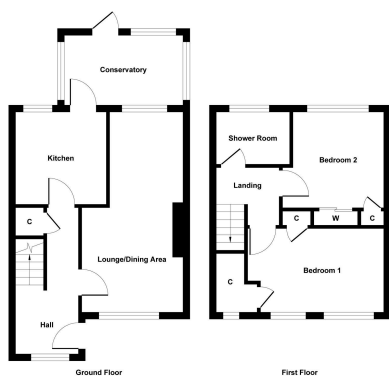

Illustration for identification purposes only. Measurements are approximate, not to scale.
Produced by Elements Property

Our Offices

51 Hamilton Street, Saltcoats, Ayrshire, KA21 5DX
Tel: 01294 606700 & Fax: 01294 464827

22 Bank Street, Irvine, Ayrshire, KA12 0AG
Tel: 01294 278306 & Fax: 01294 272886

83 Main Street, Kilwinning, Ayrshire, KA13 6AN
Tel: 01294 557506 & Fax: 01294 558552
Email: property@taylorandhenderson.co.uk

espc rightmove  zoopla  OnTheMarket



DISCLAIMER: Whilst we endeavour to make these particulars as accurate as possible, they do not form part of any contract of offer, nor are they guaranteed. Measurements are approximate and in most cases are taken with a digital/sonic-measuring device and are taken to the widest point. We have not tested the electricity, gas or water services or any appliances. Photographs are reproduced for general information and it must not be inferred that any item is included for sale with the property. If there is any part of this that you find misleading or simply wish clarification on any point, please contact our office immediately when we will endeavour to assist you in any way possible.