



GARDEN STIRLING BURNET

10 CHURCH STREET
DUNBAR, EAST LoTHIAN, EH42 1HA

 3	 2	EPC RATING B	COUNCIL TAX BAND B
---	---	---------------------	---------------------------



SUMMARY

This traditional main-door ground-floor flat is a beautiful three-bedroom residence which offers stylish modern interiors and a sought-after coastal lifestyle in Dunbar. It is immaculately decorated in crisp white throughout, and it is equipped with a highly fashionable kitchen and two on-trend shower rooms. This impeccable home also boasts a fantastic location in the town, set close to the High Street within easy reach of excellent amenities, bus and rail links, and schools. In addition, it is just a short stroll from Dunbar's beaches and historic harbour - perfect for relaxing strolls by the sea. This fantastic residence will certainly appeal to a very wide demographic of buyers and anyone seeking a coastal home that is finished to a high standard in true move-in condition.

Extras: all fitted floor and window coverings, light fittings, and integrated appliances (five-burner gas hob, raised oven, fridge/freezer, dishwasher, and washing machine) to be included.

FEATURES

- Ground-floor flat fully renovated in 2018
- Situated in the Dunbar conservation area
- Private main-door entrance
- Welcoming entrance hall
- Stylish open-plan kitchen/living/dining room
- Ultra-modern kitchen design
- Principal suite with built-in wardrobes
- Two additional bedrooms (one with storage)
- Contemporary en-suite shower room
- Premium family shower room with a double walk-in rainfall shower
- Unrestricted on-street parking
- Gas central heating and double glazing





OFFERS TO:
22 Hardgate
Haddington
EH41 3JS

Tel: 01620 825 368
Fax: 01620 824 671

DX540733 Haddington

espc

HOUSE SALES

If you have a house to sell, we provide free pre-sales advice, including valuation. We will visit your home and discuss in detail all aspects of selling and buying, including costs and marketing strategy, and will explain GSB Properties' comprehensive services.

1. While these Sales Particulars are believed to be correct, their accuracy is not warranted and they do not form any part of any contract. All sizes are approximate.
2. Interested parties are advised to note interest through their solicitor as soon as possible in order to be kept informed should a Closing Date be set. The seller will not be bound to accept the highest or any offer.

FLOORPLAN

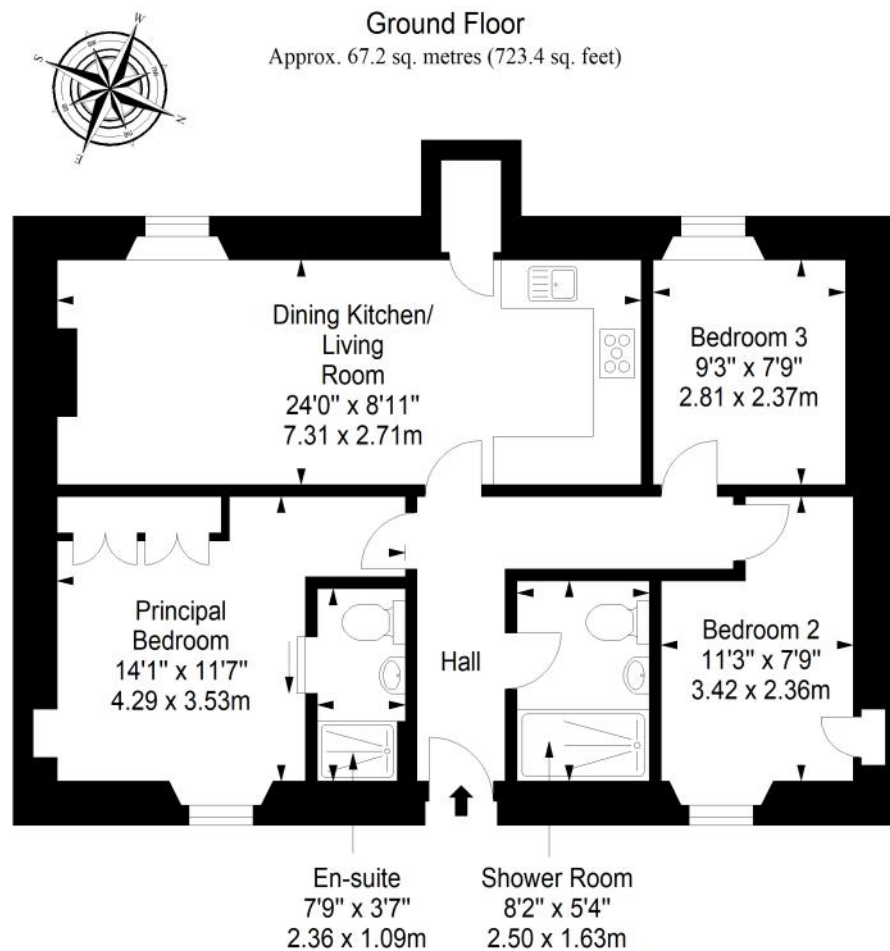

Total area: approx. 67.2 sq. metres (723.4 sq. feet)