





## 3 BEDROOM TERRACED HOME

This sophisticated home provides the ideal in flexible family living space.

The modern studio-designed kitchen and family/dining area is open plan, enjoying access to the patio via French doors, allowing you to extend your living on a sunny day or when friends are round.

Downstairs you also enjoy a separate (yet interconnecting) lounge, downstairs WC, excellent storage and welcoming vestibule, while on the first floor you'll be greeted by a spacious upper landing, off which find two double bedrooms and a single (perfect as a home office, nursery or hobby room), all enjoying fitted wardrobes. The Allan's light and airy ambience is complemented with a high specification family bathroom.



### Features

- The Allan is a 3 bedroom mid terraced home
- 3 bedroom terraced home - overall size 902 sq. ft.
- A clever downstairs design allows you to create a flowing entertaining space, or separate spaces for everyday family life by simply closing over the interconnecting doors
- Cala's high specification throughout, including 1.8m fence, solar panels and a studio-designed kitchen with Siemens integrated appliances included
- An open plan kitchen/dining room with French doors connecting out to the rear garden
- Private driveway
- Excellent energy efficiency with a PEA rating: B
- Our Allan showhome is available to view at our nearby West Craigs development; arrange your viewing today
- Council Tax – TBC
- Management fee - Annual Factor Fee £170.37, Plus £50 Float Fee

[CLICK HERE to view the Virtual Tour](#)



## GROUND FLOOR



## FIRST FLOOR

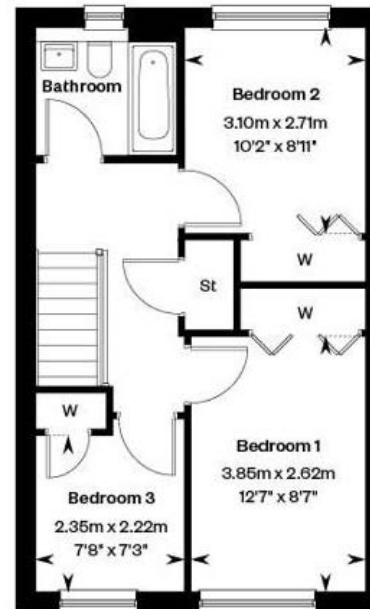

**GILSON GRAY**

LAW • PROPERTY • FINANCE

GILSONGRAY.CO.UK

### EDINBURGH

29 Rutland Square  
EH1 2BW  
0131 516 5366



### GLASGOW

160 West George Street  
G2 2HQ  
0141 530 2021



### EAST LoTHIAN

33 Westgate  
EH39 4AG  
01620 893 481



### DUNDEE

11 South Tay Street  
DD1 1NU  
01382 201 000



### BORDERS

01890 880 008



@gilsongrayprop



gilson gray property



gilson gray property



@gilsongrayprop



CHARTERED FIRM

rightmove

Zoopla.co.uk

OnTheMarket

These particulars were prepared on the basis of our own knowledge of the local area and, in respect of the property itself, information supplied to us by our clients; all reasonable steps were taken at the time of preparing these particulars to ensure that all details contained in them were accurate. All statements contained in the particulars are for information only and all parties should not rely upon them as statements or representations of fact. In particular, (a) descriptions, measurements and dimensions, which may be quoted in these particulars are approximate only and (b) all references to conditions, planning permission, services, usage, constructions, fixtures and fittings and movable items contained in the property are for guidance only. Our clients may instruct us to set a closing date for offers at short notice and therefore if you wish to pursue interest in this property, you should immediately instruct your solicitor to note interest with us. Our clients reserve the right to conclude a bargain for the sale of the above subjects or any part thereof ahead of a notified closing date and will not be obliged to accept either the highest or indeed any offer for the above subjects or any part thereof. All measurements have been taken using a sonic tape and cannot be regarded as guaranteed given the limitations of the device. Services and/or appliances referred to in these particulars have not been tested and no warranty is given that they are in full working order.