

# 13 Meadowpark

Haddington, EH41 4DS



1 bed



1 bath



1 public





## Key Features

- Living room with ample dining space
- Spacious double bedroom
- Separate kitchen
- Bathroom
- Useful entrance porch
- Floored attic space
- Private south-west facing rear garden

EPC: C

Council Tax: Band C







We are delighted to present this beautifully presented, main door upper flat located in the desirable residential area of Haddington.

An outside stone stair at the rear of the building takes you to the front door which enters into the useful porch and hallway giving access to each room. The property comprises of an entrance hallway, spacious living room with ample space for dining and the bonus of a log burner, there is a separate well equipped kitchen, double bedroom and bathroom.

The property has a fully floored attic space with Velux window. There is a private south-west facing garden together with a shared drying area to the rear of the property along with an external storage cupboard. The property also benefits from gas central heating, double glazing and on-street parking.



Viewing

By Appointment call 07828 468 308

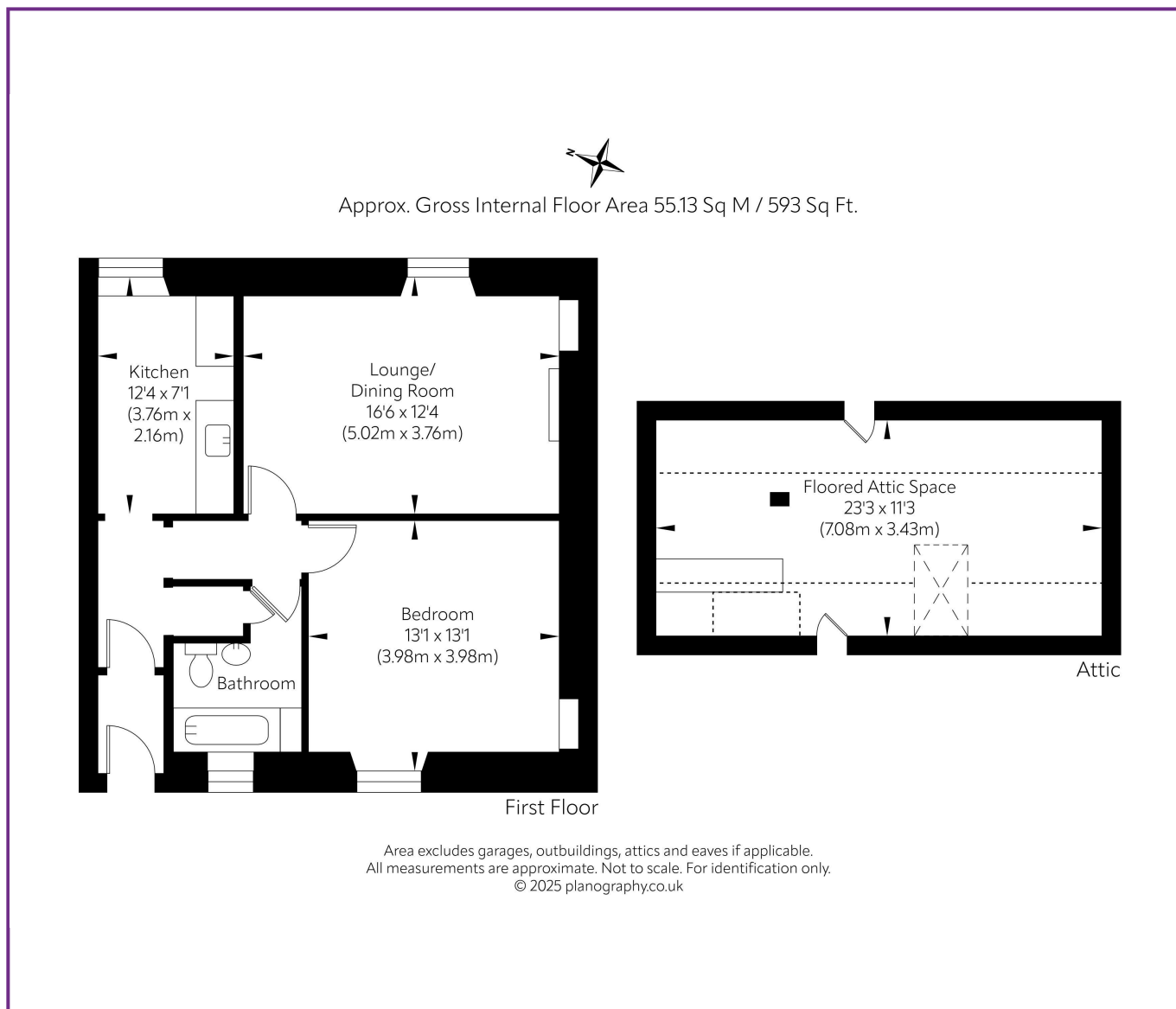

116 Colinton Road, Edinburgh EH14 1BY T: 0131 564 1159 E: [info@rd-legalservices.co.uk](mailto:info@rd-legalservices.co.uk)

espc rightmove ZOOPLA

OnTheMarket

PrimeLocation.com



Disclaimer: These particulars do not form part of any contract or missive to be entered into with a prospective purchaser. All statements and measurements contained herein are believed to be correct but are not warranted or guaranteed. Intending purchasers must satisfy themselves as to the accuracy. No guarantee is given as to the working conditions of any appliance mentioned in these particulars. The photographs shown solely belong to RD Legal.