



# End Terraced Villa

17 Enterkine, Kilwinning, KA13 6LW



[taylorandhenderson.co.uk](http://taylorandhenderson.co.uk)

1		3		1		N/A	<b>EPC</b> rating
---	--	---	--	---	--	-----	----------------------

# 17 Enterkine

Taylor and Henderson are delighted to bring to the market this end terraced villa located within established residential area close to local amenities and public bus routes. The accommodation on offer comprises reception hallway, lounge, generous sized kitchen with door leading to the rear garden, on the ground floor. Upstairs boasts 2 double bedrooms, single bedroom and fully tiled bathroom. The property also benefits from gas central heating and double glazing. The garden grounds are easily maintained with the front being laid in monobloc and the rear is paved. Kilwinning offers a wide range of local amenities to include shops, schooling at both primary and secondary levels, bus routes and excellent road links to both Glasgow and Ayr with mainline rail links with Glasgow to the north and Ayr to the south.

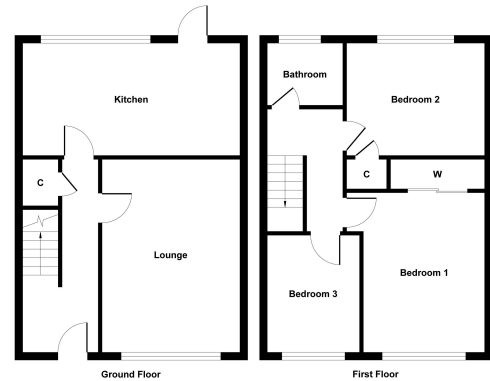
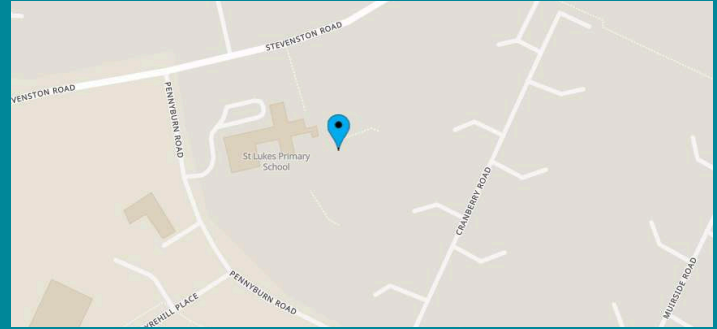

Illustration for identification purposes only, measurements are approximate, not to scale. Produced by Elements Property

Lounge	16' x 11'4
Kitchen	17'7 x 9'8
Bedroom 1	13' x 9'7
Bedroom 2	11'1 x 9'9
Bedroom 3	9'9 x 7'8
Bathroom	9'9 x 7'8

Viewing  
Through solicitors on 01294 606700

Email  
[property@taylorandhenderson.co.uk](mailto:property@taylorandhenderson.co.uk)

Reference E490600