



# Terraced Villa

10 Keir Hardie Court, Beith, KA15 1DW



# 10 Keir Hardie Court

Taylor & Henderson are delighted to bring to the market this rarely available mid terraced villa located within a popular residential area. The accommodation comprises entrance hallway, lounge with dining area, fitted kitchen with door to the rear garden all on the ground floor. The upper level comprises 2 double bedrooms (both with built in storage cupboards) and a bathroom. The property further benefits from double glazing & generous storage. The front garden is mainly laid with chips with a paved path to the left hand side leading to the front door. The enclosed rear garden has a paved patio area, few steps leading up to the paved walk way and lawn area. There is gated fence to the rear of the garden path. The property is directly across from Bellsdale football park and is conveniently situated within easy access of all local amenities, including local shops, sports and recreational facilities, schools and regular public transport services. Beith offers good road and rail links to Glasgow, neighbouring Ayrshire towns and the M8 motorway network, thus providing ease of travel throughout West Central Scotland.

Lounge	21'1 x 11'2
Hallway	15'7 x 7'8
Kitchen	9'9 x 7'8
Bedroom 1	14'7 x 10'7
Bedroom 2	11'4 x 10'1
Bathroom	7'1 x 5'7

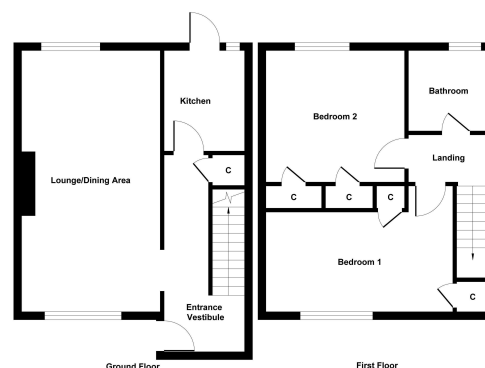
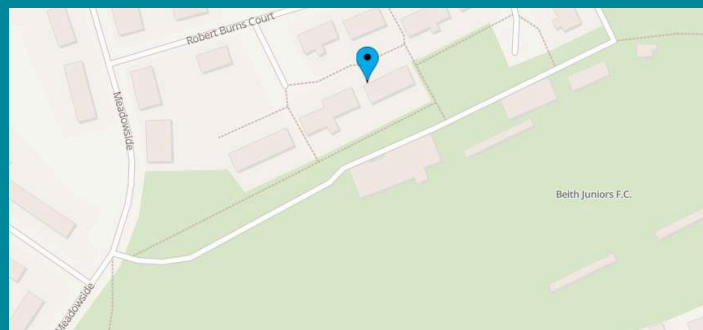

Illustration for identification purposes only, measurements are approximate, not to scale.  
Produced by Elements Property

Viewing  
Through solicitors on 01294 606700

Email  
[property@taylorandhenderson.co.uk](mailto:property@taylorandhenderson.co.uk)

Reference E495344



rightmove

zoopla

OnTheMarket



Taylor  
HENDERSON  
PROPERTY LTD

DISCLAIMER: Whilst we endeavour to make these particulars as accurate as possible, they do not form part of any contract of offer, nor are they guaranteed. Measurements are approximate and in most cases are taken with a digital/sonic-measuring device and are taken to the widest point. We have not tested the electricity, gas or water services or any appliances. Photographs are reproduced for general information and it must not be inferred that any item is included for sale with the property. If there is any part of this that you find misleading or simply wish clarification on any point, please contact our office immediately when we will endeavour to assist you in any way possible.