

## Terraced Villa

4 Medine Court, Beith, KA15 2DH



## 4 Medine Court

Taylor and Henderson are delighted to bring to the market this rarely available terraced villa which is situated within close proximity of the Town Centre and all local amenities. The accommodation on offer comprises entrance hall, modern fitted kitchen, lounge with generous storage cupboard and patio doors out to the enclosed garden all on the ground floor. The upper level boasts 2 double bedrooms, 1 single bedroom and a family bathroom with over bath shower. The property also benefits from gas central heating, double glazing and controlled entry system. The property is conveniently situated within easy access of all local amenities, including local shops, , sports and recreational facilities, schools and regular public transport services. Beith offers good road and rail links to Glasgow, neighbouring Ayrshire towns and the M8 motorway network, thus providing ease of travel throughout West Central Scotland.

Entrance Vestibule	8'0 x 6'0
Kitchen	8'0 x 8'0
Lounge	16'1 x 15'0
Bathroom	7'0 x 6'0
Bedroom 1	12'0 x 8'1
Bedroom 2	11'0 x 8'1
Bedroom 3	9'0 x 6'0

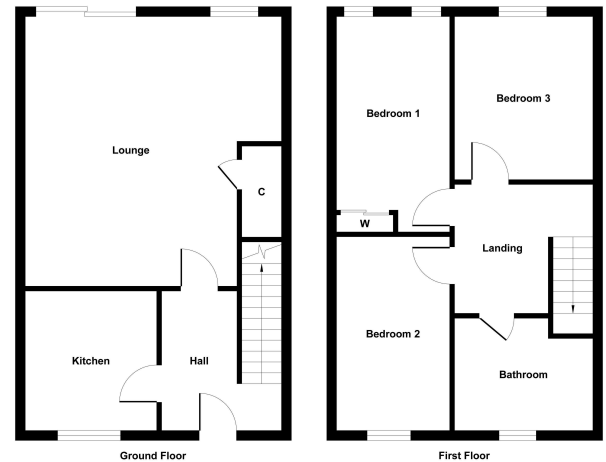
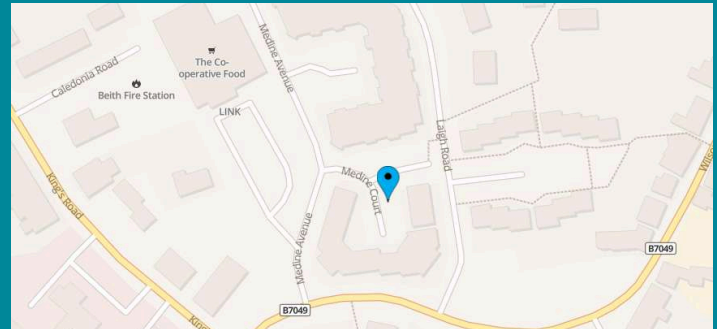

Illustration for identification purposes only, measurements are approximate, not to scale.  
Produced by Elements Property

Viewing  
Through solicitors on 01294 606700

Email  
[property@taylorandhenderson.co.uk](mailto:property@taylorandhenderson.co.uk)

Reference E502307